

Powered Pallet Truck

Mamba-Mini



Technical Information

Drive Train And Steering

- Heavy Duty 24V Drive Motor with sealed bearings provides a powerful traction system.
- Super Quiet Direct Drive Transmission with large roller bearing is oiled for life.
- SepEx control system provides smooth acceleration and energy saving dynamic braking.
- The drive motor, transmission, brakes and drive wheel are coupled to the all new Control Handle.
- The complete Drive and Steering system is securely mounted within the all steel chassis for maximum protection.

Structural

- The power section is of heavy duty construction, for maximum durability.
- The fork carriage is an integrally welded unit with robust, heavy duty channeled forks and reinforced fork tips.
- Easily accessible lubrication points provide for easy preventive maintenance for greater reliability and longer service life.

Hydraulic System

- Built in pressure relief valve protects the system from overloads.
- A heavy duty gear pump assures smooth and quiet lift and lower performance with minimal power consumption.

Electrical System

- 24V system powered by two 12v 70AH maintenance free batteries.
- The Curtis transistorised programmable Control System allows infinite control of machine functions.
- Benefits include smooth speed response, increased usable battery energy per charge, extended motor life and regenerative braking.
- Direction, Horn and Lift/Lower Controls are housed in the Control Handle.

Wheels

Polyurethane Wheels:

Drive: 252mm diameter x 63mm

Load : 73mm diameter x 98mm

Castor: 99.5mm diameter x 40mm

Travel Speed

Empty - up to 4.5 kph

Laden - up to 3.6 kph

Safety Features

- Regenerative, Dynamic Braking
- Belly button reversing switch
- Ergonomic full function control handle
- Ergonomically safe butterfly type speed controls
- Deadman braking applies brake and cuts power
- Wrap around hand guards
- Emergency power disconnect
- Electronic overload protection.
- In built smart charger
- Hydraulic overload protection
- Infinitely variable speed control

| Information | | Mamba-mini |
|-------------|--------------------------------------|--------------|
| 1 | Rated Capacity | 1361 kg |
| 2 | Load Centre (C) | 600 mm |
| 3 | Lifting Height (h) | 120 mm |
| 4 | Lowered Fork Height (h3) | 85 mm |
| 5 | Raised Fork Height (h2) | 200 mm |
| 6 | Fork Size (width e / Length L1) | 185-1150 mm |
| 7 | Fork Width, Outer (b1) | 685 mm |
| 8 | Overall Dimensions - Width (B) | 704 mm |
| 9 | Overall Dimensions - Length (L) | 1570-420 mm |
| 10 | Overall Dimensions - Wheel Base (Y) | 1222 mm |
| 11 | Swing Angle | 80 Deg |
| 12 | Steering Angle | 180 Deg |
| 13 | Lifting Speed with and without load | 56 mm |
| 14 | Lowering Speed with and without load | 57 mm |
| 15 | Drive Motor | .65 KW |
| 16 | Lift Motor | .8 KW |
| 17 | Battery (Maintenance Free) | 2x 12V |
| 18 | Drive Wheel (D2) | 252 x 63 mm |
| 19 | Load Wheel (D1) | 73 x 98 mm |
| 20 | Castor Wheels | 99.5 x 40 mm |
| 21 | Gradient with and without load | 5/7 % |
| 22 | Turning Radius (Wa) | 1384 mm |
| 23 | Weight (Without Battery) | 244 kg |

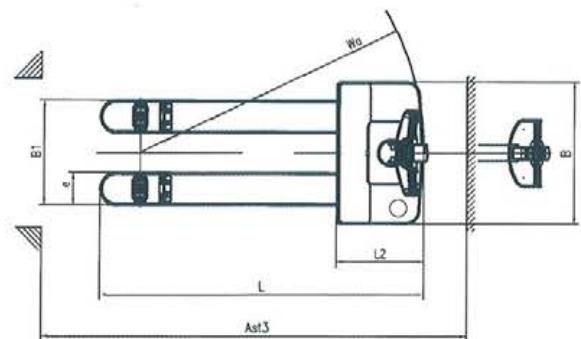
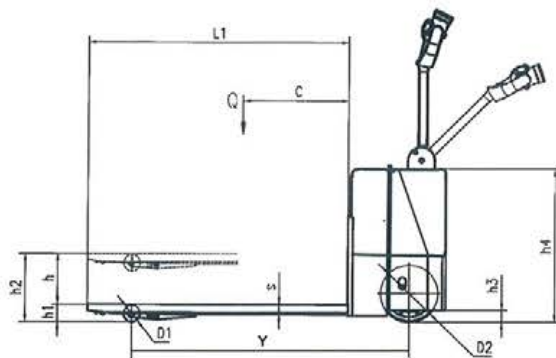

For more information on our
Product and Services please call:



Sales & Rental: **(65) 6662 2211**
Parts: **(65) 6662 2275**
Service: **(65) 6662 2215**

metaquip@tanchong.com

Distributor:
MetaQuip T C Industrial Pte Ltd
23 Jalan Buroh Singapore 619479
Tel: (65) 6265 3666
Fax: (65) 6264 1666

Powered Pallet Truck

Mamba-3

Technical Information

Drive Train And Steering

- Heavy Duty 24V Drive Motor with sealed bearings provides a powerful traction system.
- Super Quiet Direct Drive Transmission with large roller bearing is oiled for life.
- AC control system
- The complete Drive and Steering system is securely mounted within the all steel chassis for maximum protection.
- Power steering.

Structural

- The power section is of heavy duty construction, for maximum durability.
- 4 point suspension with spring loaded drive section.
- The fork carriage is an integrally welded unit with robust, heavy duty channeled forks and reinforced fork tips.
- Easily accessible lubrication points provide easy preventive maintenance for greater reliability and longer service life.

Hydraulic System

- Built in pressure relief valve protects the system from overloads.
- A heavy duty gear pump assures smooth and quiet lift and lower performance with minimal power consumption.

Electrical System

- Stand alone Smart - Charger
- 24V system powered by 210AH Traction Battery.
- Direction, Horn and Lift/ Lower Controls are housed in the Control Handle.
- Benefits include smooth speed response, increased usable battery energy per charge, extended motor life and regenerative braking.
- High performance, low maintenance AC drive through reliable Curtis US manufactured inverter controller.

Wheels

Polyurethane Wheels:

Drive: 248mm diameter x 65mm wide Quick Change Type

Load : 80mm diameter x 120mm wide

Castor: 115mm diameter x 55mm wide



Travel, Lift and Lower Speeds

Travel Speed: Empty - up to 3.6 kph
Laden - up to 3.3 kph

Lift Speed : Empty - up to 60 mm per sec
Laden - upto 56 mm per sec

Safety Features

- Dynamic Braking
- Belly button reversing switch
- Ergonomic full function control handle
- Ergonomically safe butterfly type speed controls
- Deadman braking applies brake and cuts power
- Wrap around hand guards
- Emergency power disconnect
- Electronic overload protection.
- Smart Charger
- Hydraulic overload protection
- Infinitely variable speed control

| Information | | Mamba-3 |
|-------------|---------------------------------------|-----------------|
| 1 | Rated Capacity | 2250 kg |
| 2 | Load Centre (C) | 600 mm |
| 3 | Lifting Height (h) | 125 mm |
| 4 | Lowered Fork Height (h3) | 85 mm |
| 5 | Raised Fork Height (h2) | 205 mm |
| 6 | Fork Size - Width (e) / Length (L1) | 185 - 1150 mm |
| 7 | Fork Width, Outer (b1) | 685 mm |
| 8 | Overall - Width (B) | 780 mm |
| 9 | Overall - Length (L) Rear Length (L2) | 1820 - 600 mm |
| 10 | Overall - Wheel Base (Y) | 1360 mm |
| 11 | Swing Angle | 80 deg |
| 12 | Steering Angle | 180 deg |
| 13 | Lifting Speed with and without load | 56 - 60 mm -sec |
| 14 | Lowering Speed with and without load | 57 - 59 mm -sec |
| 15 | Drive Motor (AC) | 1.5 KW |
| 16 | Lift Motor | 2.0 KW |
| 17 | Battery | 24V |
| 18 | Drive Wheel (D2) | 248 x 65 mm |
| 19 | Load Wheel (D1) | 80 x 120 mm |
| 20 | Castor Wheels | 90 x 47 mm |
| 21 | Gradient with and without load | 5 / 7 % |
| 22 | Turning Radius (Wa) | 1520 mm |
| 23 | Weight (Without Battery) | 440 kg |

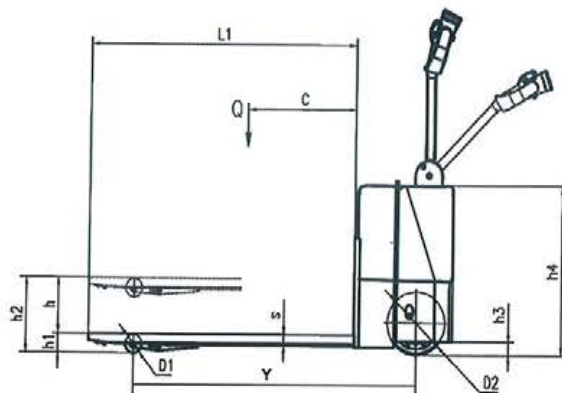
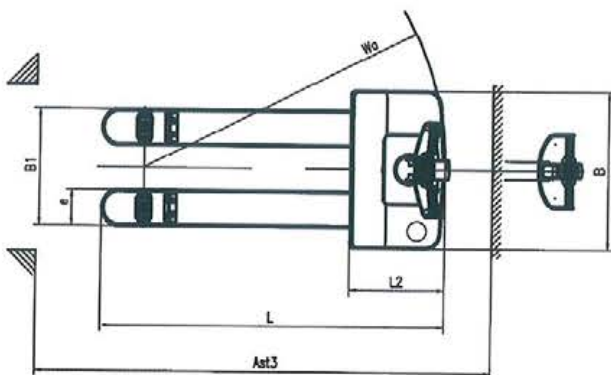

For more information on our
Product and Services please call:



Sales & Rental: **(65) 6662 2211**

Parts: **(65) 6662 2275**

Service: **(65) 6662 2215**

metaquip@tanchong.com

MQTC

Distributor:
MetaQuip T C Industrial Pte Ltd
23 Jalan Buroh Singapore 619479
Tel: (65) 6265 3666
Fax: (65) 6264 1666



www.tanchong.com

Powered Pallet Truck

Mamba-4

Technical Information

Drive Train And Steering

- Heavy Duty 24V Drive Motor with sealed bearings provides a powerful traction system.
- Super Quiet Direct Drive Transmission with large roller bearing is oiled for life.
- AC control system
- The complete Drive and Steering system is securely mounted within the all steel chassis for maximum protection.
- Power steering.

Structural

- The power section is of heavy duty construction, for maximum durability.
- 4 point suspension with spring loaded drive section.
- The fork carriage is an integrally welded unit with robust, heavy duty channeled forks and reinforced fork tips.
- Easily accessible lubrication points provide easy preventive maintenance for greater reliability and longer service life.

Wheels

Polyurethane Wheels:

Drive: 248mm diameter x 65mm wide Quick Change Type

Load : 80mm diameter x 120mm wide

Castor: 115mm diameter x 55mm wide

Hydraulic System

- Built in pressure relief valve protects the system from overloads.
- A heavy duty gear pump assures smooth and quiet lift and lower performance with minimal power consumption.

Electrical System

- 24V system powered by 270AH Traction Battery.
- Stand alone Smart - Charger
- Benefits include smooth speed response, increased usable battery energy per charge, extended motor life and regenerative braking.
- Direction, Horn and Lift/ Lower Controls are housed in the Control Handle.
- High performance, low maintenance AC drive through reliable Curtis US manufactured inverter controller.



Travel, Lift and Lower Speeds

Travel Speed: Empty - up to 3.6 kph
Laden - up to 3.3 kph

Lift Speed: Empty - up to 60 mm per sec
Laden - up to 56 mm per sec

Lowering: Empty - up to 59 mm per sec
Speed: Laden - up to 57 mm per sec

Safety Features

- Dynamic Braking
- Belly button reversing switch
- Ergonomic full function control handle
- Ergonomically safe butterfly type speed controls
- Deadman braking applies brake and cuts power
- Wrap around hand guards
- Emergency power disconnect
- Electronic overload protection.
- Smart Charger
- Hydraulic overload protection
- Infinitely variable speed control

| Information | | Mamba-4 |
|-------------|---------------------------------------|-----------------|
| 1 | Rated Capacity | 2500 kg |
| 2 | Load Centre (C) | 600 mm |
| 3 | Lifting Height (h) | 125 mm |
| 4 | Lowered Fork Height (h1) | 85 mm |
| 5 | Raised Fork Height (h2) | 205 mm |
| 6 | Fork Size - Width (e) / Length (L1) | 185 - 1150 mm |
| 7 | Fork Width, Outer (b1) | 685 mm |
| 8 | Overall - Width (B) | 790 mm |
| 9 | Overall - Length (L) Rear Length (L2) | 2320 - 760 mm |
| 10 | Overall - Wheel Base (Y) | 1360 mm |
| 11 | Swing Angle | 80 deg |
| 12 | Steering Angle | 180 deg |
| 13 | Lifting Speed with and without load | 56 - 60 mm -sec |
| 14 | Lowering Speed with and without load | 57 - 59 mm -sec |
| 15 | Drive Motor (AC) | 1.5 KW |
| 16 | Lift Motor | 2.0 KW |
| 17 | Battery | 24V |
| 18 | Drive Wheel (D2) | 248 x 65 mm |
| 19 | Load Wheel (D1) | 80 x 120 mm |
| 20 | Castor Wheels | 115 x 55 mm |
| 21 | Gradient with and without load | 5 / 7 % |
| 22 | Turning Radius (Wa) | 1710 mm |
| 23 | Weight (Without Battery) | 543 kg |

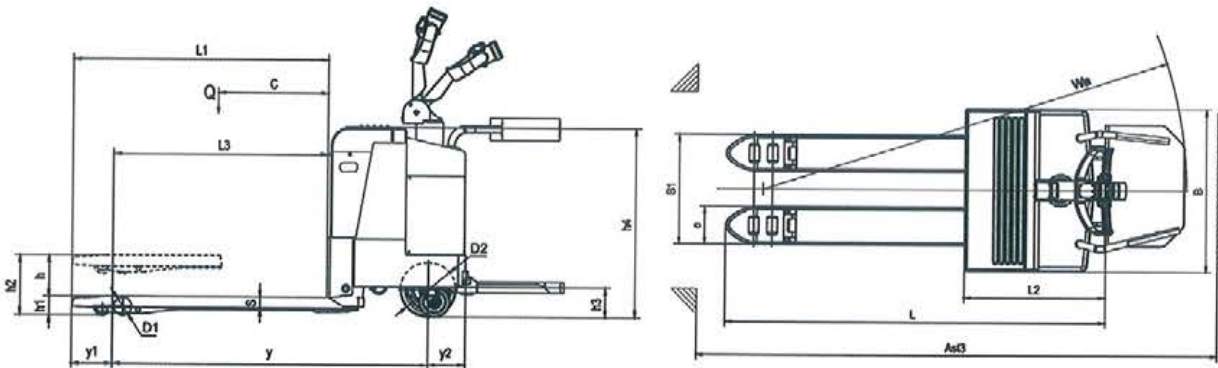

For more information on our
Product and Services please call:



Sales & Rental: **(65) 6662 2211**

Parts: **(65) 6662 2275**

Service: **(65) 6662 2215**

metaquip@tanchong.com

MQTC

Distributor:
MetaQuip T C Industrial Pte Ltd
23 Jalan Buroh Singapore 619479
Tel: (65) 6265 3666
Fax: (65) 6264 1666

TANCHONG
INTERNATIONAL

www.tanchong.com